

ART.5000

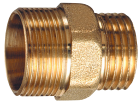

ART.5010

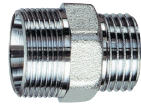

ART.5050

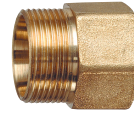

ART.5060

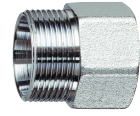

ART.5100

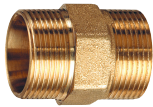

ART.5110

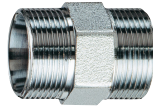

ART.5250



ART.5260



ART.5300



ART.5310



ART.5350



ART.5360



ART.5400



ART.5410



ART.5450



ART.5460



ART.5500



ART.5510



ART.5550



ART.5555



ART.5552



ART.5557



ART.8426-8429



ART.8427-8428

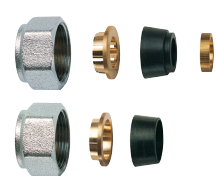

ART.6051



ART.6054



ART.6052



ART.6055



**1 RACCORDERIA PER TUBAZIONE IN RAME**

La linea di raccordi a compressione meccanica per acqua e aria è adatta all'utilizzo su tubi rame di diametro 10, 12, 14, 15, 16, 18, 20 e 22. La gamma comprende: niplex maschio, niplex femmina, gomito maschio, gomito femmina e raccordo a muro disponibili anche completi di kit di tenuta a seconda delle diverse misure del tubo.

**N.B.** I Raccordi per tubo rame 18, 20, 22 vengono forniti completi di calotte e kit di tenuta.

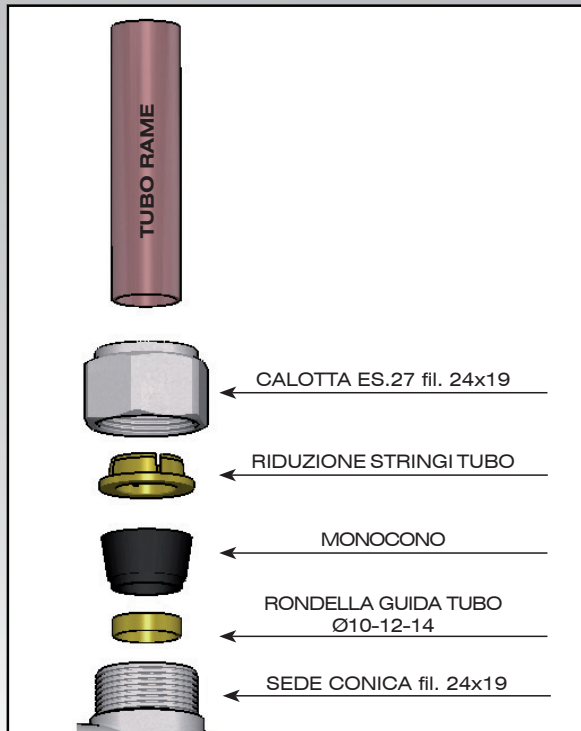
**TUBO RAME E ACCIAIO Ø10 - Ø12 - Ø14 - Ø15 - Ø16**

Il kit di tenuta per tubo rame è composto da:  
 N°1 Riduzione (Ø10-12-14-15-16)  
 N°1 Monocono (Ø10-12-14-15-16)  
 N°1 Rondella per guida tubo (Ø10-12-14)

**Normativa UNI EN 1254**

I raccordi a compressione sono realizzati in conformità alle seguenti norme:

**UNI EN 1254 - 2**

Rame e leghe di rame - Raccorderia idraulica  
 Raccordi per tubazioni di rame con terminali a compressione.

**2 RACCORDERIA PER TUBAZIONE IN PLASTICA E MULTISTRATO**

La linea di raccordi a compressione meccanica per acqua e aria è adatta all'utilizzo su tubi plastica e multistrato di diametro esterno 10, 11, 12, 14, 15, 16, 17, 18 e 20. La gamma comprende: niplex maschio, niplex femmina, gomito maschio, gomito femmina e raccordo a muro disponibili anche completi di kit di tenuta a seconda delle diverse misure del tubo.

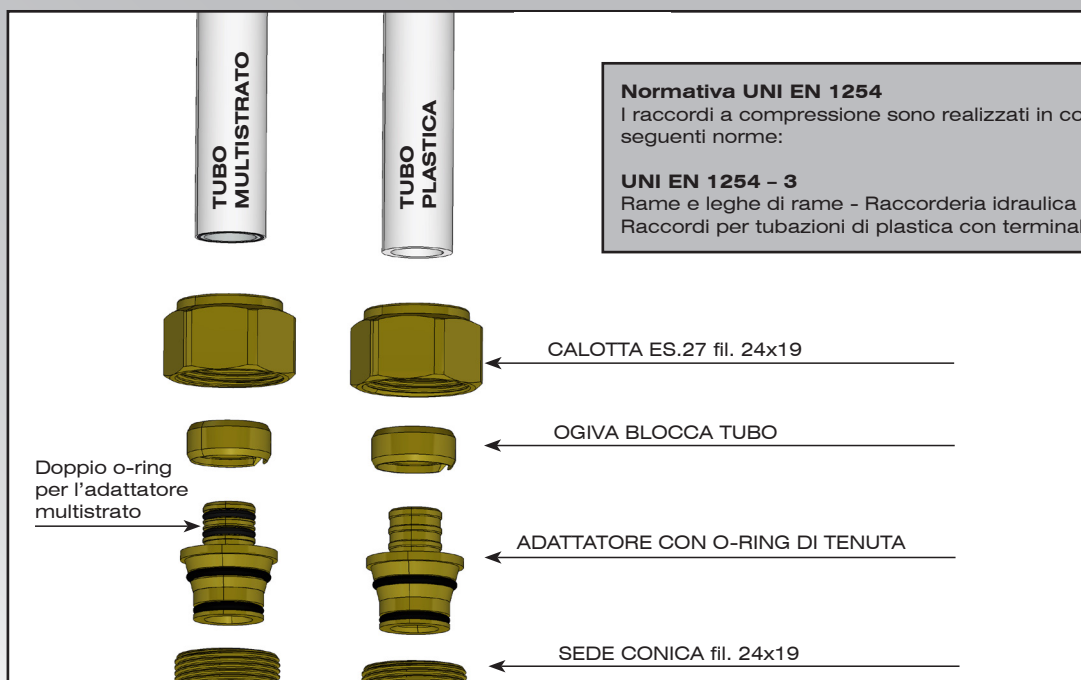
**TUBO PLASTICA E MULTISTRATO FINO AL Ø20**

**Normativa UNI EN 1254**

I raccordi a compressione sono realizzati in conformità alle seguenti norme:

**UNI EN 1254 - 3**

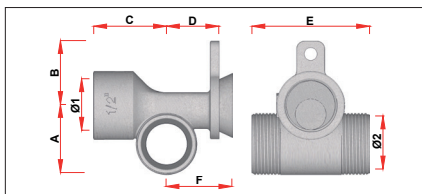
Rame e leghe di rame - Raccorderia idraulica  
 Raccordi per tubazioni di plastica con terminali a compressione.

**4 CARATTERISTICHE DIMENSIONALI**

**ART. 5650-5840**

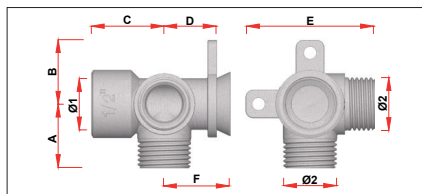
CODICE	Ø1	Ø2	A	B	C	D	E	F
5650 12	1/2"	24x19	27	25	29	21	46	26
5840 12	1/2"	1/2"	27	25	29	21	46	26

**ART. 5700-5845**

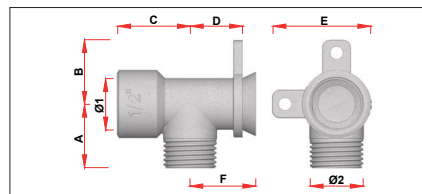
CODICE	Ø1	Ø2	A	B	C	D	E	F
5700 12	1/2"	24x19	27	25	29	21	50	26
5845 12	1/2"	1/2"	27	25	29	21	50	26

**ART. 5750-5850**

CODICE	Ø1	Ø2	A	B	C	D	E	F
5750 12	1/2"	24x19	27	25	29	21	38	26
5850 12	1/2"	1/2"	27	25	29	21	38	26

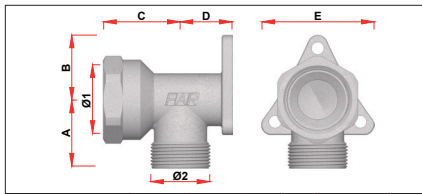
**ART. 5550-5555-5830**

CODICE	Ø1	Ø2	A	B	C	D	E
5550-5555 12	1/2"	24x19	27	26	28	21	45
5550-5555 34	3/4"	24x19	28	26	31	21	45
5830 12	1/2"	1/2"	26	26	28	21	45

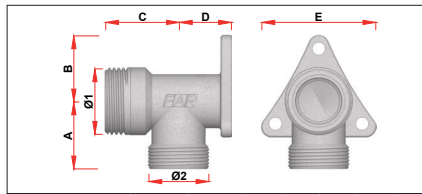
**ART. 5552-5557**

CODICE	Ø1	Ø2	A	B	C	D	E
5552-5557 34	3/4"	24x19	27	25	29	21	46

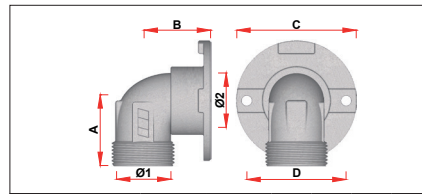
**ART. 5600-5610-5835**

CODICE	Ø1	Ø2	A	B	C	D
5600-5610 12	24x19	1/2"	26	26	46	38
5835 12	1/2"	1/2"	26	26	46	38

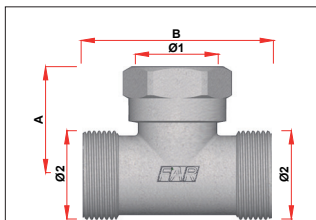
**ART. 5450-5460-5825**

CODICE	Ø1	Ø2	A	B
5450-5460 12	1/2"	24x19	29	51
5450-5460 34	3/4"	24x19	31	55
5825 12	1/2"	1/2"	29	52

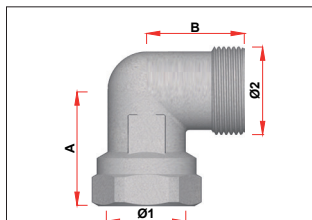
**ART. 5300-5310-5815**

CODICE	Ø1	Ø2	A	B
5300-5310 12	1/2"	24x19	31	27
5300-5310 34	3/4"	24x19	31	27
5300-5310 1	1"	24x19	37	31
5815 12	1/2"	1/2"	31	27
5815 34	3/4"	3/4"	33	30

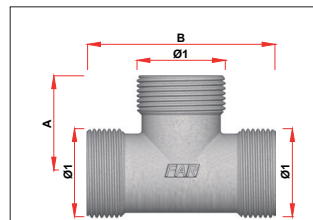
**ART. 5400-5410-5505-5515-5820**

CODICE	Ø1	A	B
5400-5410 12	24x19	26	51
5505-5515 12	1/2"	27	51
5505-5515 34	3/4"	28	60
5505-5515 1	1"	34	68
5820 12	1/2"	27	52

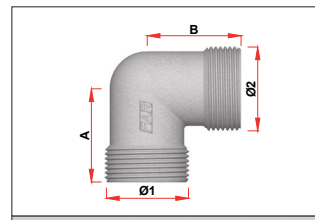
**ART. 5250-5260-5350-5360-5810**

CODICE	Ø1	Ø2	A	B
5250-5260 12	1/2"	24x19	36	27
5250-5260 34	3/4"	24x19	31	27
5250-5260 1	1"	24x19	33	30
5350-5360 12	24x19	24x19	27	27
5810 12	1/2"	1/2"	27	27
5810 34	3/4"	3/4"	27	27

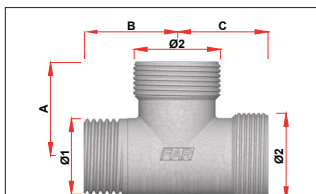
**ART. 5500-5510**

CODICE	Ø1	Ø2	A	B	C
5500-5510 12	1/2"	24x19	27	26	25

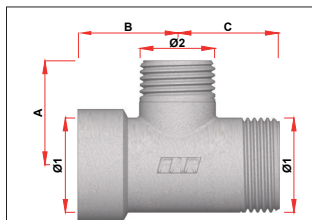
**ART. 5506-5516**

CODICE	Ø1	Ø2	A	B	C
5506-5516 34	3/4"	1/2"	27	25	26

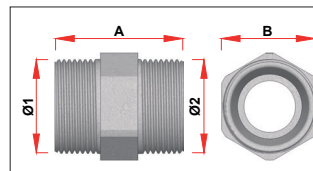
**ART. 5100-5110-5800**

CODICE	Ø1	Ø2	A	B
5100-5110 12	24x19	24x19	33	24
5800 12	1/2"	1/2"	31	21
5800 34	3/4"	3/4"	33	27

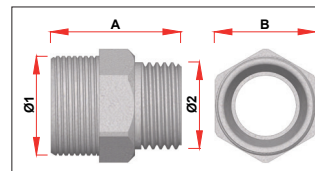
**ART. 5000-5010**

CODICE	Ø1	Ø2	A	B
5000-5010 38	24x19	3/8"	30	24
5000-5010 12	24x19	1/2"	31	24
5000-5010 34	24x19	3/4"	33	29
5000-5010 1	24x19	1"	37	34

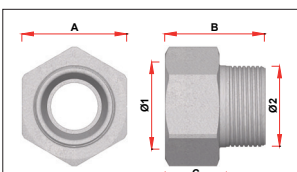
**ART. 5050-5060-5805**

CODICE	Ø1	Ø2	A	B	C
5050-5060 38	3/8"	24x19	26	26	16
5050-5060 12	1/2"	24x19	26	28	17
5050-5060 34	3/4"	24x19	31	30	18
5050-5060 1	1"	24x19	38	31	20
5805 12	1/2"	1/2"	24	27	17
5805 34	3/4"	3/4"	31	30	19

**5 CARATTERISTICHE TECNICHE**

<b>Temperatura d'esercizio</b>	<b>0-95°C</b>
<b>Pressione massima d'esercizio</b>	<b>10 bar</b>
<b>Coppia di serraggio</b>	<b>40 Nm</b>
<b>Riduzione e rondella</b>	<b>CW614N - CW617N</b>
<b>Monocono</b>	<b>Gomma anticalore</b>
<b>Calotta</b>	<b>CW617N giallo - cromato</b>
<b>Corpo raccordo</b>	<b>CW617N giallo - cromato</b>
<b>Corpo adattatore</b>	<b>CW617N</b>